

Construction are made from glued wood, galvanized steel and HDPE.

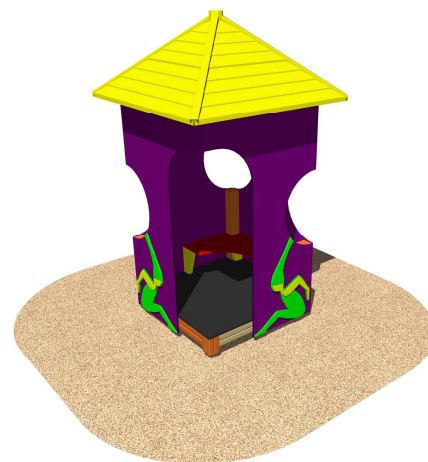

5 children

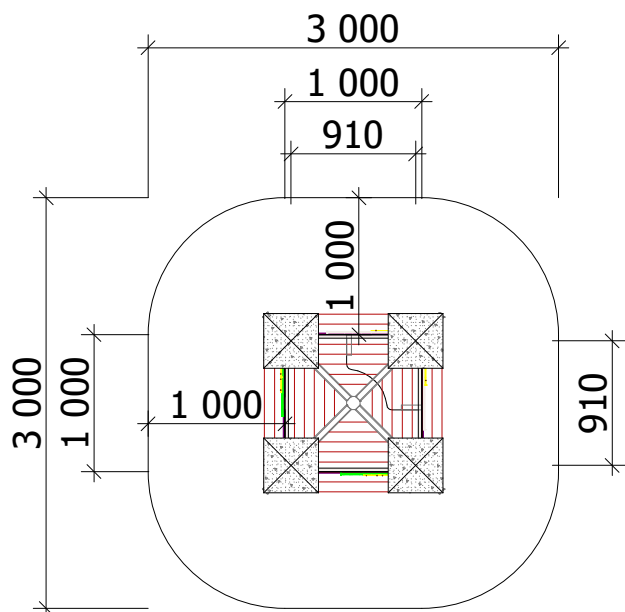
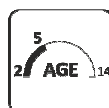

Children from 2 - 5 years

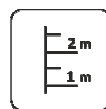

The Fall height
H=0.40 m



Weight
135 kg



Assembly
6 h
(without excavation
and concreting)

Minimal required area - 8 m²

Length: 1 000 mm
Width: 1 000 mm
Height: 2 300 mm

Playground are provided for outdoor use in supervising of adults

Length of safety area: 3 000 mm
Width of safety area: 3 000 mm
Required safety area: 8 m²

Equipment safety checkings must be performed once in a week in high vandalism risk areas.

Maintenance are required once in every 3 months, depending on usage

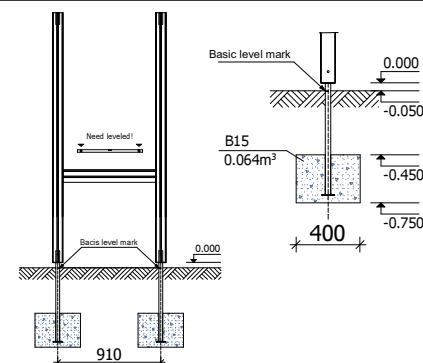

Play equipment are established with concreted steel foundation in equipment location. Equipment are suitable for use in two days after concreting, when the foundation are totally solid. During assembling there are not children allowed in area.

Adequate temperature

T_{min} - 33.2 °C
T_{max} +70.1 °C



Snow load

1.22 kN/m²



Wing load

Strength 753.3 N

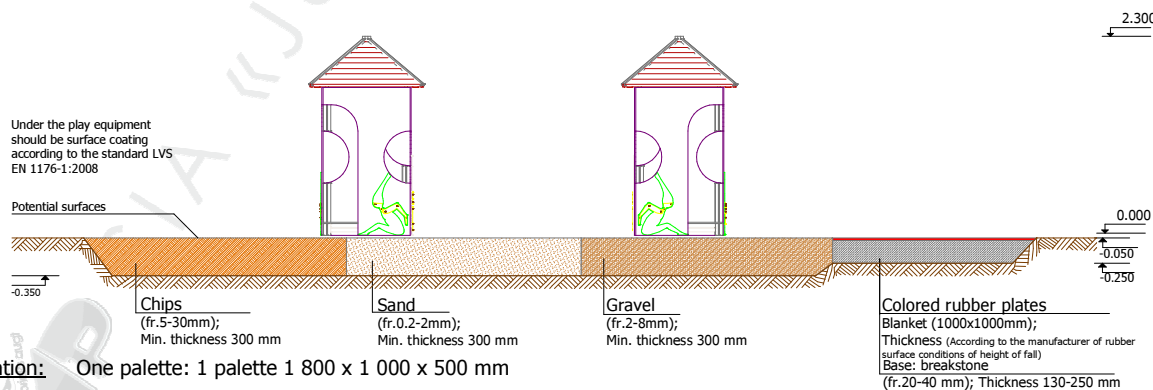

Transportation: One palette: 1 palette 1 800 x 1 000 x 500 mm

Spare parts: All needed spare parts and elements, when warranty time expires can be ordered in „Jūrmalas Mežaparki” Ltd., and all the goods will be ready for delivery in 3 days.

According to LVS EN 1176:2008

Manufactured according to:

