

ROBINIA RB1920



1+



4 kids



17,0 m²



Material specification

- Construction made of Robinia - very durable acacia wood with a diameter of ~ 12 - 18 cm without sharp edges, resistant to weather conditions,
- Side panels made of Robinia - very durable acacia wood without sharp edges, resistant to weather conditions
- Colorful elements made of durable HPL plate, resistant to weather conditions,
- Windows made of Plexiglas mirrors in a safe cover made of HPL plate, resistant to weather conditions,
- Seats/backrests made of Robinia - very durable acacia wood without sharp edges, resistant to weather conditions,
- Screws covered with plastic caps and/or stainless steel screws,



Facilitating disability



easy access



seats



shelters



integration



Intellectual development



sight



Physical development



hiding



rest



community





2

number of interactive elements

Product technical sheet

ROBINIA RB1920

Product data

| | |
|-----------------------------|---------------------|
| Length | 140 cm |
| Width | 140 cm |
| Total height | 190 cm |
| Age group | 1+ years |
| Number of users | 4 kids |
| Safety zone | 17,0 m2 |
| Free fall height | <60 cm |
| In accordance with norm EN | 1176-1:2017+A1:2023 |
| Availability of spare parts | YES |

Data is subject to change without prior notice.

Additional information

- equipment adapted for the disabled; intended for public playgrounds;
- equipment has a certificate issued by an accredited entity or a declaration of conformity;
- no sharp edges or chinks that would pose a danger of jamming the head, fingers or any other body parts;
- anchoring on flat surface, 80/70/60 cm deep;
- render is for reference only, the actual appearance of the equipment and its color may vary;

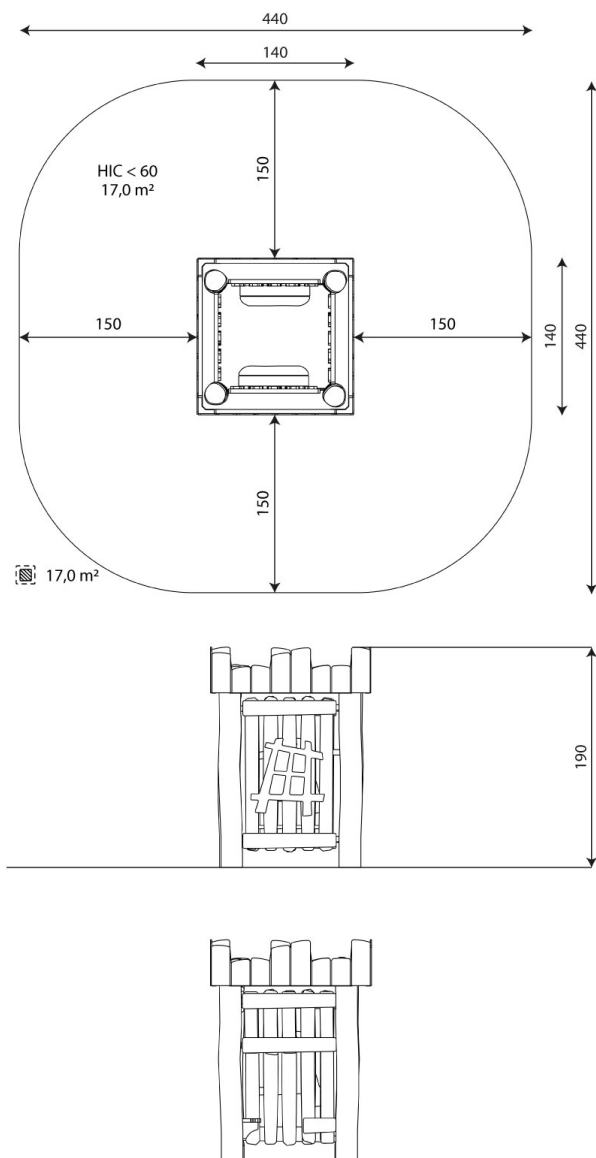

Guarantee

30 30 year guarantee - Durability of steel and stainless steel structural elements

15 15 year guarantee - Durability of steel and stainless steel structures of mobile devices; durability of Robinia wood structural elements

10 10 year guarantee - Structural strength of HDPE, 100% recycled HDPE and HPL elements; structural elements made of 100% recycled material (composite)

5 5 year guarantee - Corrosion resistance of stainless steel and hot-dip galvanized and powder-coated steel elements, resistance to bark beetles and rotting of wooden structural elements

Detailed information in the guarantee card



Surfaces according to EN 1176-1:2017+A1:2023

| | Description (mm) | Layer thickness (cm) | Maximum fall heights (cm) |
|---------------------------------|------------------------------|----------------------|---------------------------|
| Turf/ top layer of soil (A,B,C) | - | - | ≤100 |
| bark (A,C) | Particle size from 20 to 80 | 30 | ≤200 |
| | | 40 | ≤300 |
| woodchips (A,C) | Particle size from 5 to 30 | 30 | ≤200 |
| | | 40 | ≤300 |
| sand or gravel (A,C) | Particle size from 0,25 to 8 | 30 | ≤200 |
| | | 40 | ≤300 |
| synthetic attested (A,B,C) | Tested according to EN 1177 | | <60 |

Product technical sheet

ROBINIA RB1920

Amount of safe surface corresponding with free fall height:

HIC <60 17,0 m²

Data is subject to change without prior notice.

